

## FEATURES

- DC Brush Planetary GearMotor
- Designed for High Volume Applications
- Up to 69.44 oz-in of Continuous Torque
- 20 mm Motor Body Diameter
- Custom Versions are Available

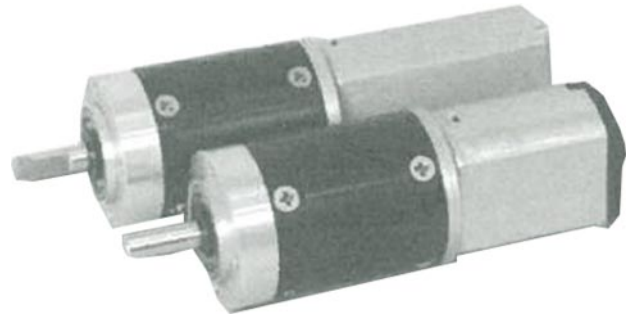

## DESCRIPTION

The BDPG-22-25 Series was designed for high volume OEM applications with low cost being the primary objective. They come in variety of power levels, sizes, and will be sure to fit your DC planetary gearmotor requirements. These motors are fully reversible. Custom options are available for these motors. The options available for customization include: optimizing speed, torque, current, voltage, cabling, wiring, connectors, and shaft modification. The BDPG-22-25 Series is a cost effective solution to manage motion control in many rotary applications including medical, semiconductor, pumps, robotics, hobby, CNC, and many other rotary applications.

## DIMENSION

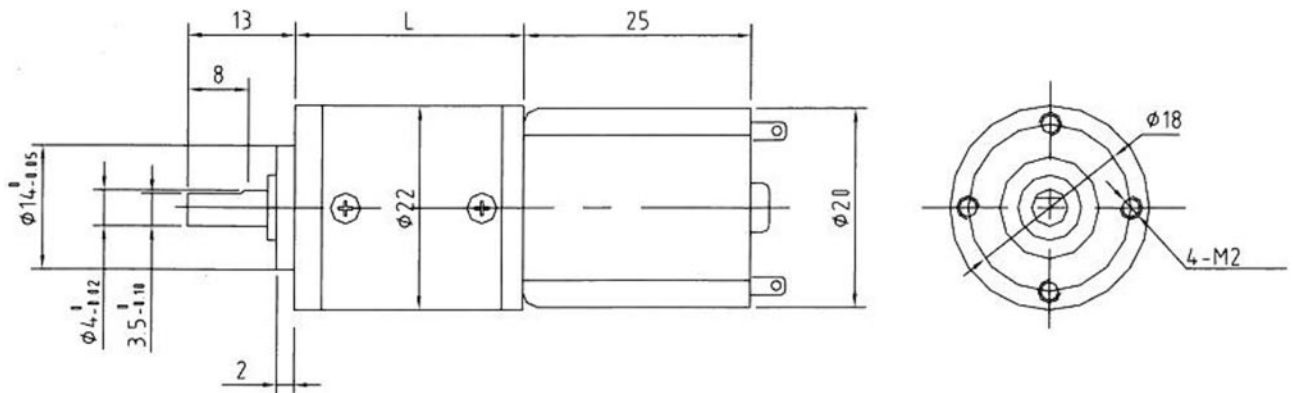

\*All units are in mm

L010457

Model #	Voltage (V)	Gear Ratio	No Load Speed (RPM)	Rated Speed (RPM)	Rated Torque (oz-in)	Weight (lbs)	L Length (mm)
BDPG-22-25-6V-6000-R51	6	51	117	82	4.44	0.146	32.5
BDPG-22-25-6V-6000-R71	6	71	84	59	6.25	0.146	32.5
BDPG-22-25-6V-6000-R100	6	100	60	42	8.75	0.146	32.5
BDPG-22-25-6V-6000-R139	6	139	43	30	12.22	0.146	32.5
BDPG-22-25-6V-6000-R189	6	189	31	22	15.28	0.152	37.5
BDPG-22-25-6V-6000-R264	6	264	22	16	22.22	0.152	37.5
BDPG-22-25-6V-6000-R369	6	369	16	11	30.55	0.152	37.5
BDPG-22-25-6V-6000-R516	6	516	11	8	43.05	0.152	37.5
BDPG-22-25-6V-6000-R720	6	720	8.3	5.8	59.72	0.152	37.5
BDPG-22-25-6V-6000-R981	6	981	6.1	4.3	69.44	0.163	42.0
BDPG-22-25-6V-6000-R1370	6	1370	4.3	3.5	69.44	0.163	42.0
BDPG-22-25-6V-6000-R1913	6	1913	3.1	2.7	69.44	0.163	42.0
BDPG-22-25-6V-6000-R2671	6	2671	2.2	2	69.44	0.163	42.0
BDPG-22-25-6V-6000-R3730	6	3730	1.6	1.5	69.44	0.163	42.0
BDPG-22-25-12V-10000-R19	12	19	526	420	2.36	0.128	28.0
BDPG-22-25-12V-10000-R27	12	27	370	296	3.33	0.128	28.0
BDPG-22-25-12V-10000-R51	12	51	196	156	5.97	0.146	32.5
BDPG-22-25-12V-10000-R71	12	71	140	112	8.33	0.146	32.5
BDPG-22-25-12V-10000-R100	12	100	100	80	11.80	0.146	32.5
BDPG-22-25-12V-10000-R139	12	139	72	57	16.66	0.146	32.5
BDPG-22-25-12V-10000-R189	12	189	53	42	20.83	0.152	37.5
BDPG-22-25-12V-10000-R264	12	264	37	30	29.16	0.152	37.5
BDPG-22-25-12V-10000-R369	12	369	27	21	41.66	0.152	37.5
BDPG-22-25-12V-10000-R516	12	516	19	15	56.94	0.152	37.5
BDPG-22-25-12V-10000-R720	12	720	13	11	69.44	0.152	37.5
BDPG-22-25-12V-10000-R981	12	981	10	8.8	69.44	0.163	42.0
BDPG-22-25-12V-10000-R1370	12	1370	7.3	6.6	69.44	0.163	42.0
BDPG-22-25-12V-10000-R1913	12	1913	5.2	4.8	69.44	0.163	42.0

Housing Material:	Metal	Radial Play of Shaft:	0.04 mm
Bearing at Output:	Sleeve Bearings	Thrust Play at Shaft:	0.3 mm
Radial Load:	1 kg	Backlash, at No-Load:	3°
Shaft Axial Load:	0.6 kg	Shaft Press Fit Force, Max	5 kg
Humidity:	20-85%	Operating Temperature:	-10°C to +80°C